

ELECTRICAL NOTES:

1. ELECTRICAL SWITCHES, OUTLETS AND FIXTURES MAY BE CHANGED ON SITE AT OWNERS DISCRETION PROVIDED THAT THE FINAL DESIGN COMPLEES WITH APPLICABLE CODE.
2. SMOKE DETECTORS SHALL HAVE A BATTERY BACKUP.
3. ARC-FAULT CIRCUIT INTERRUPTION PROTECTION SHALL BE PROVIDED FOR ALL CIRCUITS SUPPLYING POWER, EXCEPT SEE NOTE 3.
4. KITCHEN AND BATHROOM RECEPTACLES AND ALL UTILITY ROOM RECEPTACLES THAT ARE LOCATED WITHIN 6' OF THE OUTSIDE EDGE OF A LAUNDRY, UTILITY OR WET BAR SINK SHALL HAVE GROUND-FAULT CIRCUIT-INTERRUPTER PROTECTION FOR PERSONNEL. RECEPTACLES OUTLETS SHALL NOT BE INSTALLED IN A FACE-UP POSITION IN THE WORK SURFACES OR COUNTERTOPS.

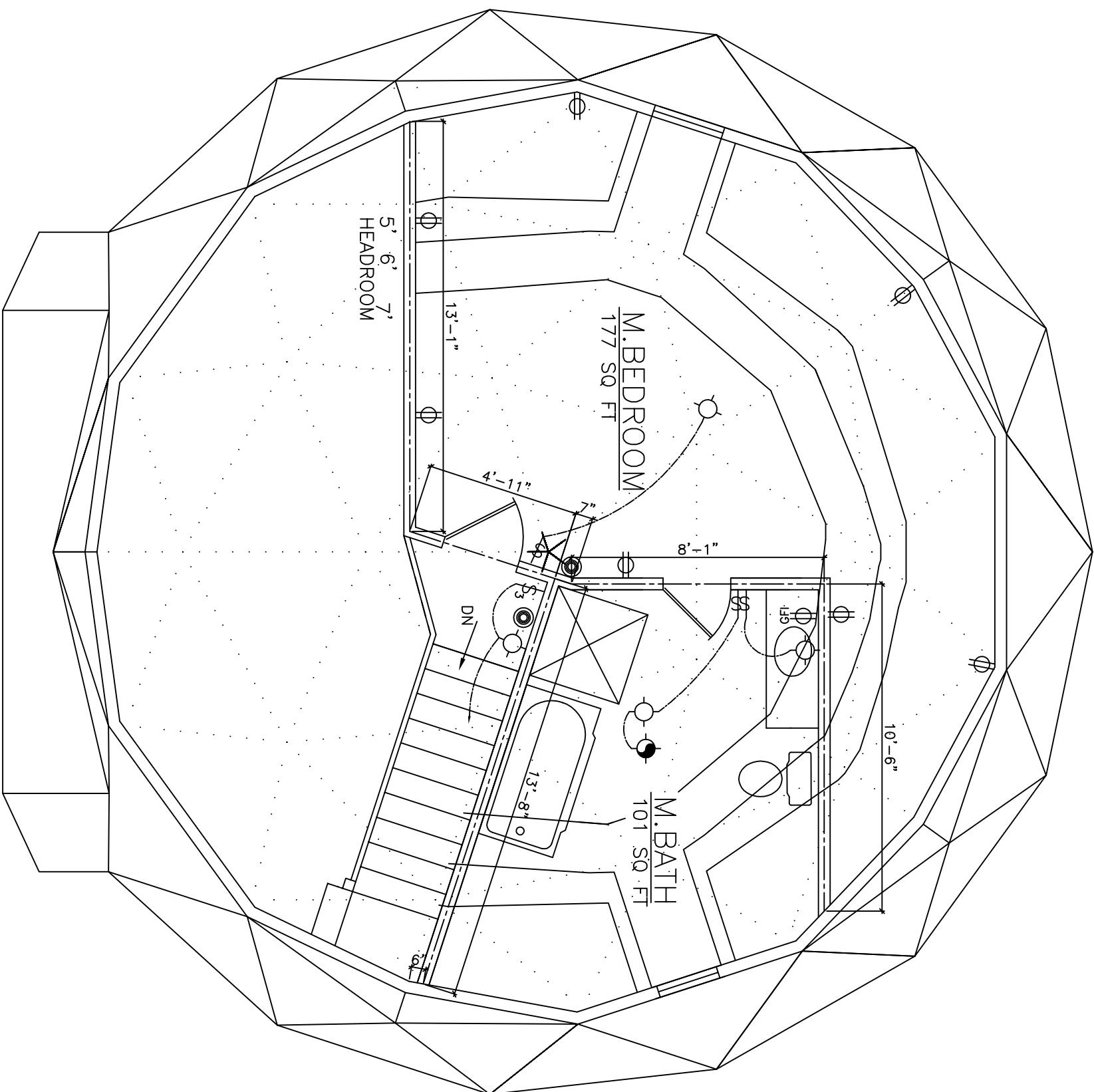

NOTES:

1. CRITICAL DIMENSIONS ARE GIVEN. OTHERS MAY BE SCALE MEASURED.
2. INTERIOR WALLS ARE DIMENSIONED TO THEIR CENTERLINE UNLESS OTHERWISE NOTED.
3. INTERIOR WALL THICKNESS SHOWN IS 4 1/2". 3 1/2" FRAMING PLUS 1/2" WALL BOARD ON BOTH SIDES. ON SITE THIS DOMES INTERIOR WALLS WILL BE CUSTOM BUILT.
4. RAD-INDICATES THE RADIUS TO THE CENTER OF THE FLOOR.
5. ENCLOSED ACCESSIBLE SPACE UNDER STAIRS SHALL HAVE WALLS, UNDER-STAIR SURFACE AND ANY SOFFITS PROTECTED ON THE ENCLOSED SIDE WITH 5/8" TYPE "X" GYPSUM BOARD.
6. LANDINGS OR FLOORS AT THE REQUIRED EGRESS DOOR SHALL NOT BE MORE THAN 1 1/2" LOWER THAN THE TOP OF THE THRESHOLD.
7. EXHAUST FANS ARE INSTALLED IN TOP CENTER OF DOME, IN EACH BATHROOM, ON THE STOVE, MICROWAVE AND CLOTHES DRYER. IN SEVERE COLD CLIMATES A HEAT RECOVERY VENTILATOR OR SIMILAR EQUIPMENT MAY BE INSTALLED TO REMOVE INTERIOR WATER VAPOR IF NEEDED.
8. NO GUTTERS, DOWN SPOUTS OR SPLASH BLOCKS. MINIMUM GRADE SHOULD BE 1" VERTICAL DROP PER 10' HORIZONTAL AWAY FROM THE FOUNDATION
9. A SIDE HINGED DOOR SHALL BE PROVIDED AS THE REQUIRED EXIT DOOR HAVING THE MINIMUM CLEAR WIDTH DIMENSION OF 32 INCHES AND A MINIMUM CLEAR HEIGHT OF 78 INCHES. THE FLOOR OR A MINIMUM 36"x36" LANDING IS REQUIRED AT EXTERIOR DOORS, WHICH MAY BE A MAXIMUM OF 7 3/4" BELOW THE TOP OF THE THRESHOLD. PROVIDED THE DOOR, OTHER THAN AN EXTERIOR STORM OR SCREEN DOOR, DOES NOT SWING OVER THE LANDING, OTHERWISE THE FLOOR OR LANDING MUST NOT BE MORE THAN 1 1/2" BELOW THE TOP OF THE THRESHOLD. A STAIRWAY OF 2 OR FEWER RISERS IS ALLOWED TO BE LOCATED ON THE EXTERIOR SIDE OF A DOOR, OTHER THAN THE REQUIRED EXIT DOOR, PROVIDED THAT THE DOOR DOES NOT SWING OVER THE STAIRWAY.

2ND FLOOR PLAN

SCALE: 1/4" = 1'-0"
 AREA: 292 SQ FT

DRAWN BY: N.K.H.
 CHECKED BY: G.B.
 DATE: 6.30.17
 DRAWING NO: 34_CHUPIS
 REVISION:

CHUPIS RESIDENCE

2ND FLOOR PLAN

DOMES PLANS FOR:

SHEET TITLE:

AMERICAN
 INGENUITY, INC.

8777 HOLIDAY SPRINGS RD
 ROCKLEDGE, FL 32955-5805
 PH. 321-639-8777 USA

SHEET NO.

A-5

COPYRIGHT 2017
 AMERICAN INGENUITY, INC.