

DOOR SCHEDULE			
SYMBOL	SIZE	QUANTITY	TYPE
1	74 3/8"x82 1/4"	1	FRENCH DOOR
2	95 1/2"x79 1/2"	1	SL. GLASS DOOR

LIVING
KITCHEN

WINDOW SCHEDULE, ROUGH OPENING

SYMBOL	SIZE	QUANTITY	TYPE	
A	2/5x3/6	1	CASEMENT EGRESS IMPACT	M.BEDROOM,
B	2/5x3/6	1	CASEMENT EGRESS, TEMPERED IMPACT	BEDROOM 1

ANDERSEN 400 SERIES PERMASHIELD: VINYL CLAD WOOD,
CW135: LOW E. SPECIAL ORDER FIRE EGRESS HARDWARE.

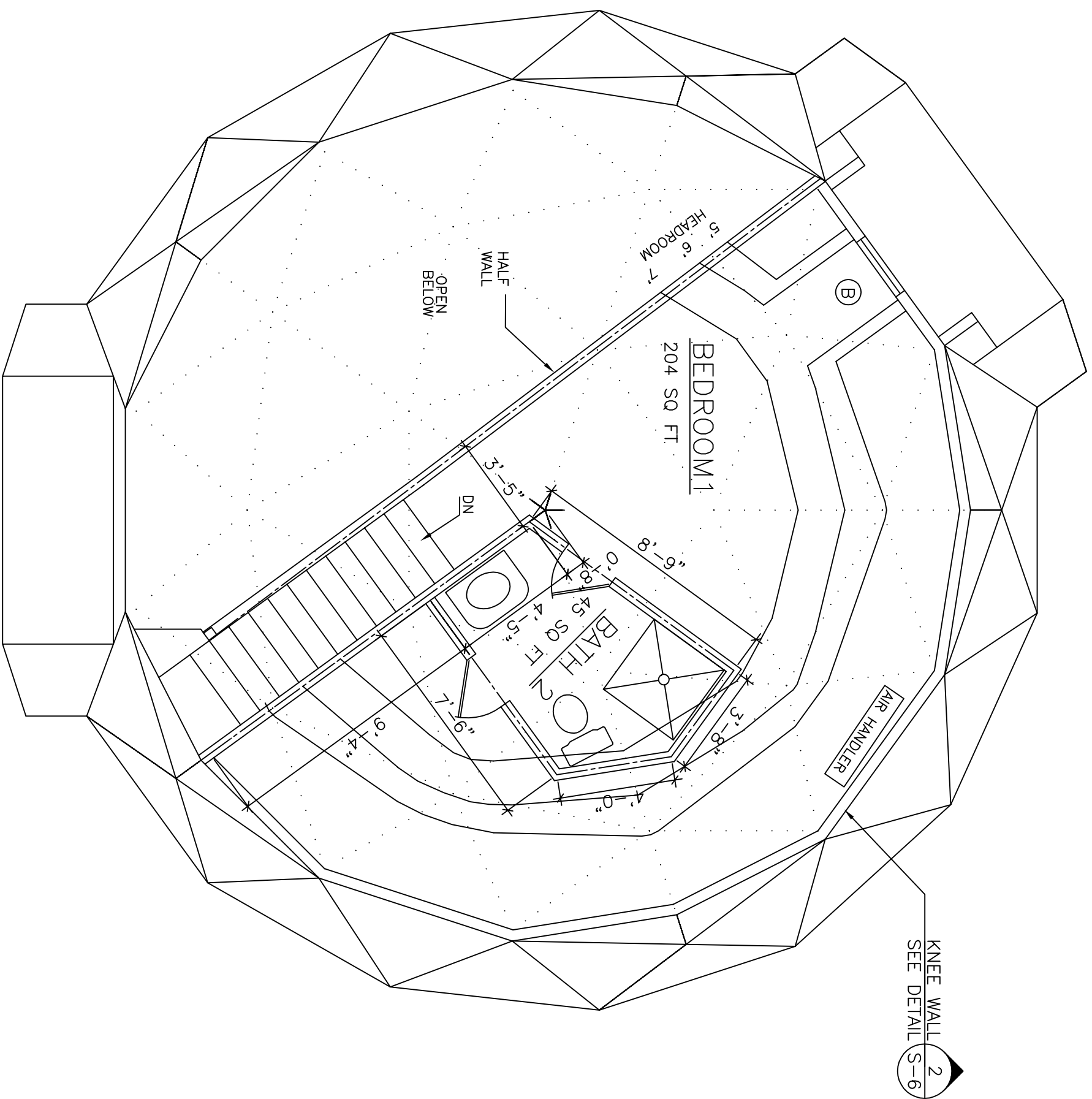

NOTES:

1. CRITICAL DIMENSIONS ARE GIVEN. OTHERS MAY BE SCALE MEASURED. SEE SHEET S-1 FOR BEARING WALL LOCATION DIMENSIONS.
2. INTERIOR WALLS ARE DIMENSIONED TO THEIR CENTERLINE UNLESS OTHERWISE NOTED.
3. INTERIOR WALL THICKNESS SHOWN IS 4 1/2", 3 1/2" FRAMING PLUS 1/2" WALL BOARD ON BOTH SIDES.
4. RAD-C INDICATES THE RADIUS TO THE CENTER OF THE FLOOR.
5. ALL BEDROOMS THAT DO NOT HAVE AN ALTERNATE EXIT MUST HAVE WINDOW QUALIFIED FOR EGRESS. MINIMUM WIDTH OF OPENING 20". MINIMUM HEIGHT 24". MIN. CLEAR OPEN AREA 5.7 SQ. FT. MAXIMUM HEIGHT FROM THE FLOOR TO THE BOTTOM OF THE OPENING 44".
6. WINDOWS FOR BEDROOMS MUST MEET EGRESS AS STATED. OTHER WINDOWS CAN BE SMALLER. EXTERIOR DOORS: THERE MUST BE ONE 36" EGRESS DOOR. U FACTOR MUST BE EQUAL OR BETTER THAN ENERGY REPORT. PERFORMANCE LABELS MUST STAY ON WINDOWS AND EXTERIOR DOORS UNTIL FINAL INSPECTION.
7. ENCLOSED ACCESSIBLE SPACE UNDER STAIRS SHALL HAVE WALLS, UNDER-STAIR SURFACE AND ANY SOFFITS PROTECTED ON THE ENCLOSED SIDE WITH 5/8" TYPE "X" GYPSUM BOARD.
8. LANDINGS OR FLOORS AT THE REQUIRED EGRESS DOOR SHALL NOT BE MORE THAN 1 1/2" LOWER THAN THE TOP OF THE THRESHOLD.
9. NO GUTTERS, DOWN SPOUTS OR SPLASH BLOCKS.

2ND FLOOR PLAN

SCALE: 1/4" = 1'-0"
AREA: 259 SQ. FT.

AMERICAN
INGENUITY, INC.

8777 HOLIDAY SPRINGS RD
ROCKLEDGE, FL 32955-5805
PH. 321-639-8777 USA

DOMES PLANS FOR:

OTTE & LAYTON RESIDENCE

SHEET TITLE:

2ND FLOOR PLAN

DRAWN BY: N.K.H.
CHECKED BY: G.B.

DATE: 1.4.16

DRAWING NO:34 OTTE&LAYTON
REVISION: 1

SHEET NO.

A-5

COPYRIGHT 2015
AMERICAN INGENUITY, INC.