

# ▲ 48' DOME GARAGE PLANNER ▲

FIRST FLOOR MAX: 1,693 sq.ft.  
 SECOND FLOOR MAX: \* 1,137 sq.ft.  
 (TO 5" HEADROOM)  
 LOFT MAX: 162 sq.ft.  
 TOTAL MAX: 2,992 sq.ft.

\* NO HIGH VAULTED CEILING.  
 STAIRS WITH TWO STEP PLATFORM.  
 FIVE SECOND FLOOR DORMERS.  
 EACH DORMER ADDING 10 SQ.FT

EACH OPENING INDICATES A POSSIBLE LOCATION FOR A 2ND FLOOR WINDOW OR DOOR DORMER. FOR ADDITIONAL LIGHT ON SECOND FLOOR INSTEAD OF INSTALLING A WINDOW DORMER, INSTALL DOOR DORMER ABOVE FIRST FLOOR STANDARD ENTRYWAY AND INSTALL LARGER WINDOW.

THE DASHED LINES INDICATE THE POSSIBLE LOCATION OF ADDITIONAL ENTRYWAYS.

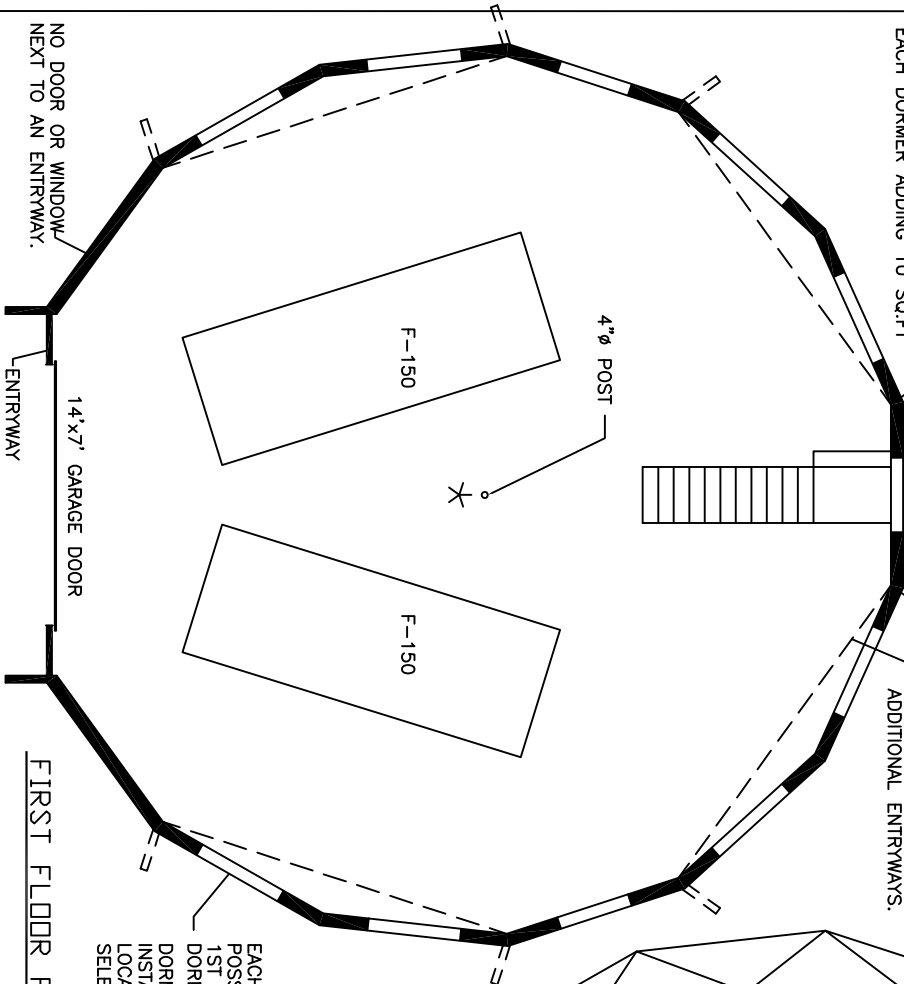

FIRST FLOOR PLAN

ENTRYWAYS MAY CONTAIN BOTH DOORS AND WINDOWS.

WHEN 48' WITH 4' RISER IS USED AS A GARAGE THE GARAGE DOOR IS 14'x7'. IF DOME BUILT WITH ADDITIONAL 2' RISER THE DOOR CAN BE 14'x9' OR 16'x7'. DUE TO THE LARGE SIZE OF THE DOME FOR STRUCTURAL INTEGRITY THREE RISERS CAN NOT BE REMOVED.

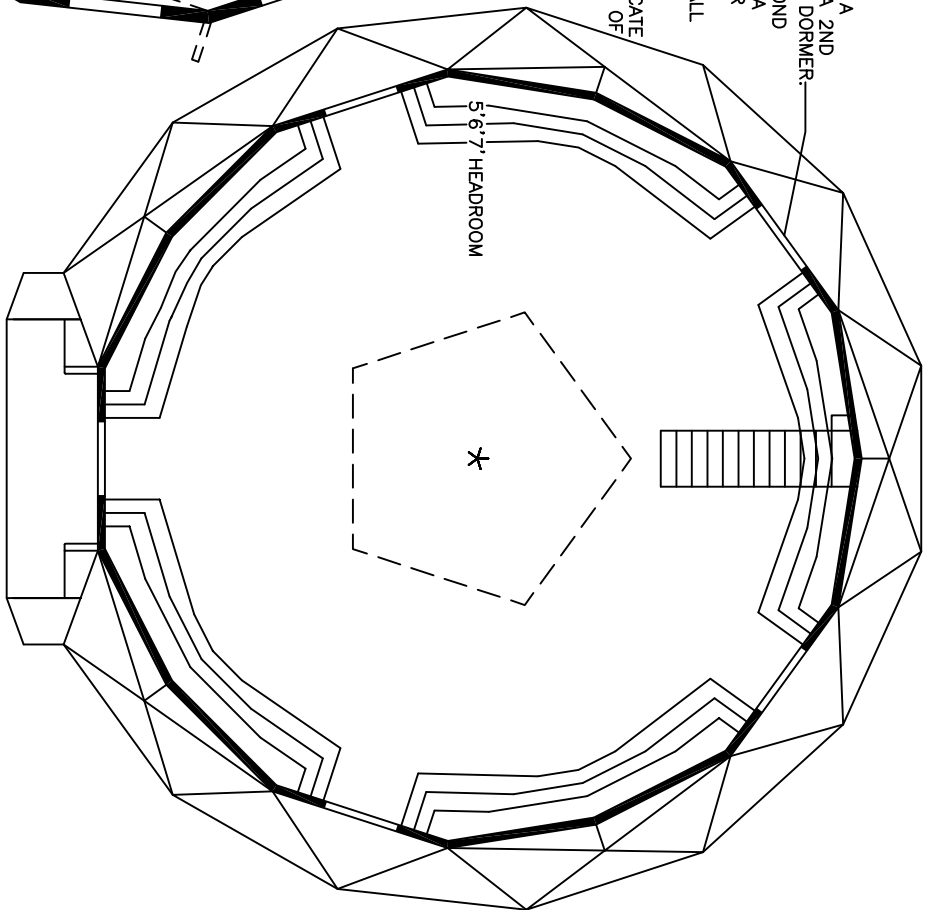

SECOND FLOOR PLAN

EACH OPENING INDICATES A POSSIBLE LOCATION FOR A 1ST FLOOR WINDOW OR DOOR DORMER. DORMER CAN'T BE INSTALLED IN BOTH LOCATIONS. SELECT ONE.

THE CENTER PENTAGON INDICATES THE OUTLINE FOR A CUPOLA, OR A CUPOLA WITH A LOFT.  
 2ND FLOOR DOOR DORMER CAN ONLY BE LOCATED OVER A 8'-0" ENTRYWAY TO CREATE A BALCONY OR INSTALL TALL WINDOW.

A SECOND FLOOR DORMER CAN ONLY BE INSTALLED WHEN THERE IS A FIRST FLOOR STANDARD ENTRYWAY DIRECTLY BELOW IT.

