

▲ 40' DOME FLOOR PLANNER ▲

FIRST FLOOR, MAX: 1,178 sq.ft.
 SECOND FLOOR, MAX:* 667 sq.ft.
 (TO 5' HEADROOM)
 LOFT, MAX: 112 sq.ft.
 TOTAL MAX: 1,957 sq.ft.

* NO HIGH VAULTED CEILING.
 STAIRS WITH TWO STEP PLATFORM.
 FIVE SECOND FLOOR DORMERS,
 EACH DORMER ADDING 9 SQ.FT

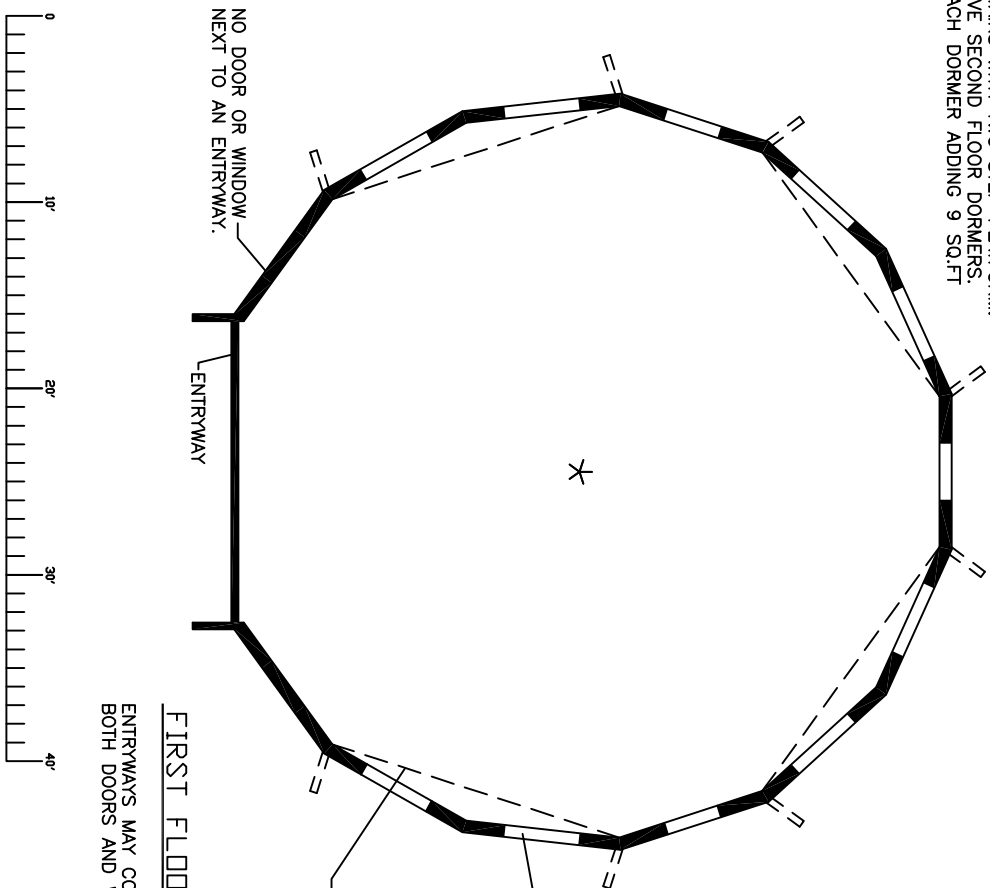

ENTRYWAYS MAY CONTAIN BOTH DOORS AND WINDOWS.

FIRST FLOOR PLAN

EACH OPENING INDICATES A POSSIBLE LOCATION FOR A 2ND FLOOR WINDOW OR DOOR DORMER.
 FOR ADDITIONAL LIGHT ON SECOND FLOOR, INSTEAD OF INSTALLING A WINDOW DORMER, INSTALL DOOR DORMER ABOVE FIRST FLOOR STANDARD ENTRYWAY AND INSTALL LARGER WINDOW.

EACH OPENING INDICATES A POSSIBLE LOCATION FOR A 1ST FLOOR WINDOW OR DOOR DORMER.
 DORMER CAN'T BE INSTALLED IN BOTH LOCATIONS. SELECT ONE.

THE DASHED LINES INDICATE THE POSSIBLE LOCATION OF ADDITIONAL ENTRYWAYS.

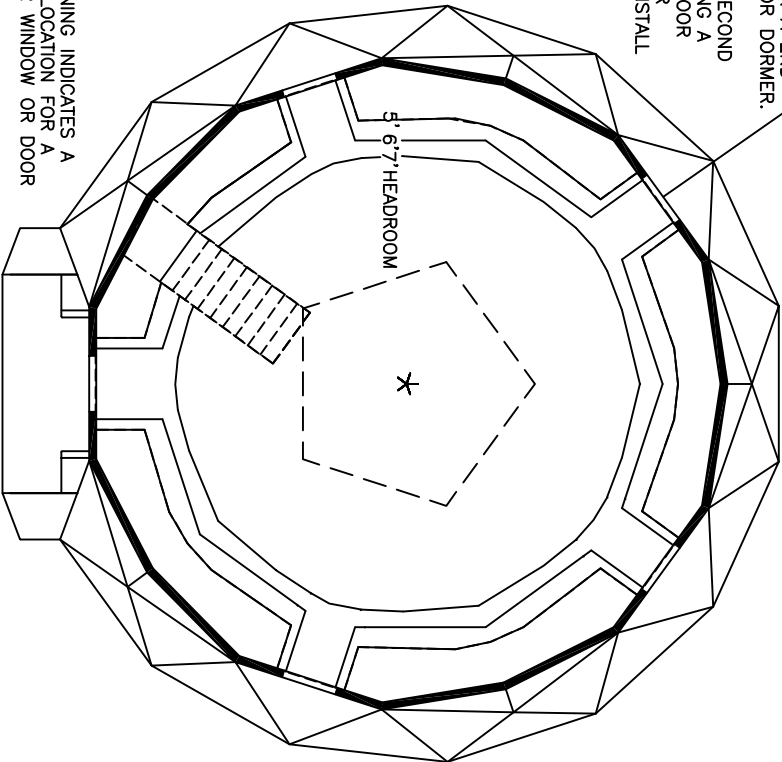

2ND FLOOR DOOR DORMER CAN ONLY BE LOCATED OVER A 8'-0" ENTRYWAY TO CREATE A BALCONY OR INSTALL TALL WINDOW.
 A SECOND FLOOR DORMER CAN ONLY BE INSTALLED WHEN THERE IS A FIRST FLOOR STANDARD ENTRYWAY DIRECTLY BELOW IT.

SECOND FLOOR PLAN