

# 45' DOME FLOOR PLANNER

FIRST FLOOR MAX: 1,489 sq.ft.  
 SECOND FLOOR MAX: \* 951 sq.ft.  
 (TO 5" HEADROOM)  
 LOFT MAX: 142 sq.ft.  
 TOTAL MAX: 2,582 sq.ft.

EACH OPENING INDICATES A POSSIBLE LOCATION FOR A 2ND FLOOR WINDOW OR DOOR DORMER.  
 FOR ADDITIONAL LIGHT ON SECOND FLOOR INSTEAD OF INSTALLING A WINDOW DORMER, INSTALL DOOR DORMER ABOVE FIRST FLOOR STANDARD ENTRYWAY AND INSTALL LARGER WINDOW.

\* NO HIGH VAULTED CEILING. STAIRS WITH TWO STEP PLATFORM. FIVE SECOND FLOOR DORMERS. EACH DORMER ADDING 10 SQ.FT

THE DASHED LINES INDICATE THE POSSIBLE LOCATION OF ADDITIONAL ENTRYWAYS.

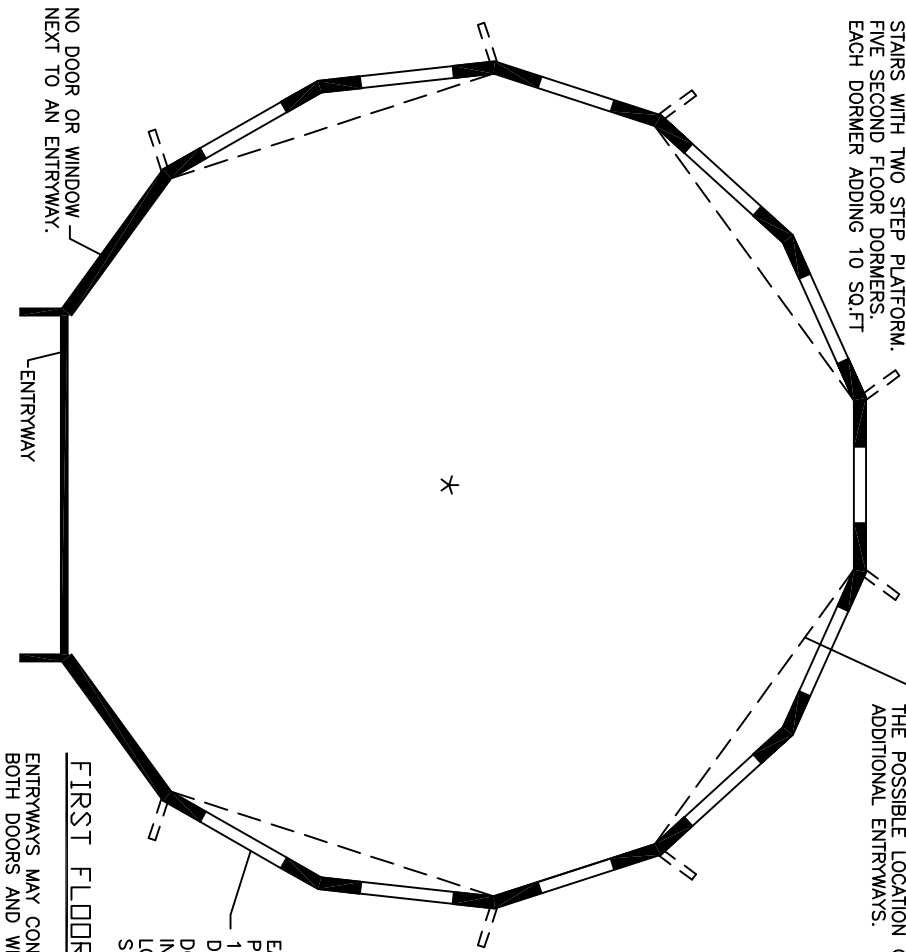

**FIRST FLOOR PLAN**  
 ENTRYWAYS MAY CONTAIN BOTH DOORS AND WINDOWS.

EACH OPENING INDICATES A POSSIBLE LOCATION FOR A 1ST FLOOR WINDOW OR DOOR DORMER. DORMER CAN'T BE INSTALLED IN BOTH LOCATIONS. SELECT ONE.

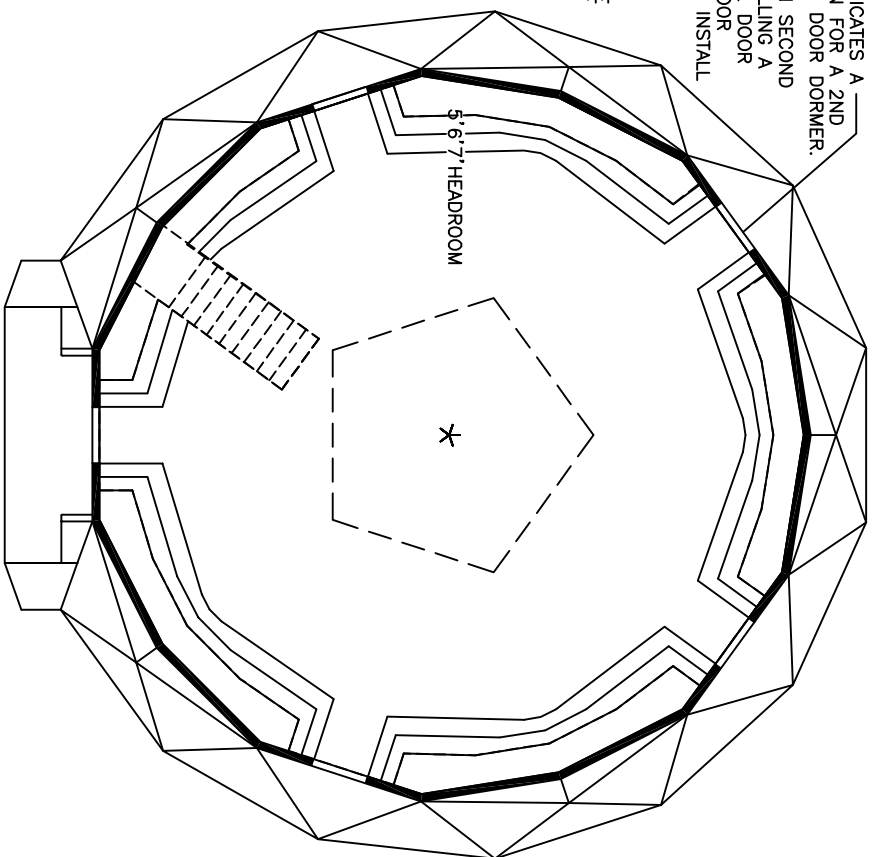

**SECOND FLOOR PLAN**  
 THE CENTER PENTAGON INDICATES THE OUTLINE FOR A CUPOLA, OR A CUPOLA WITH A LOFT.  
 2ND FLOOR DOOR DORMER CAN ONLY BE LOCATED OVER A 8'-0" ENTRYWAY TO CREATE A BALCONY OR INSTALL TALL WINDOW.  
 A SECOND FLOOR DORMER CAN ONLY BE INSTALLED WHEN THERE IS A FIRST FLOOR STANDARD ENTRYWAY DIRECTLY BELOW IT.