

- NOTES:
1. CRITICAL DIMENSIONS ARE GIVEN. OTHERS MAY BE SCALE MEASURED. SEE SHEET S-1 FOR BEARING WALL LOCATION DIMENSIONS.
  2. INTERIOR WALLS ARE DIMENSIONED TO THEIR CENTERLINE UNLESS OTHERWISE NOTED.
  3. INTERIOR WALL THICKNESS SHOWN IS 4 1/2". 3 1/2" FRAMING PLUS 1/2" WALL BOARD ON BOTH SIDES.
  4. RAD-C INDICATES THE RADIUS TO THE CENTER OF THE FLOOR.
  5. A.W.D.G. INDICATES INTERIOR WALL SECTIONS THROUGH INTERIOR WALL GEOMETRY OR PANEL SEAMS ABOVE.
  6. ELECTRICAL SWITCHES, OUTLETS AND DIMMERS ARE PAGED ON SITE AT THE FINAL DESIGN COMPLETES WITH APPLICABLE CODE.
  7. ARC-FAULT CIRCUIT INTERRUPTION PROTECTION SHALL BE PROVIDED FOR ALL CIRCUITS SUPPLYING POWER TO THE BEDROOMS.
  8. ALL BEDROOMS THAT DO NOT HAVE AN ALTERNATE EXIT MUST HAVE WINDOW OR OPENING ON EXTERIOR WITH MIN. CLEAR OPEN AREA 5.7 SQ. FT. MAXIMUM HEIGHT FROM THE FLOOR TO THE BOTTOM OF THE OPENING 44".

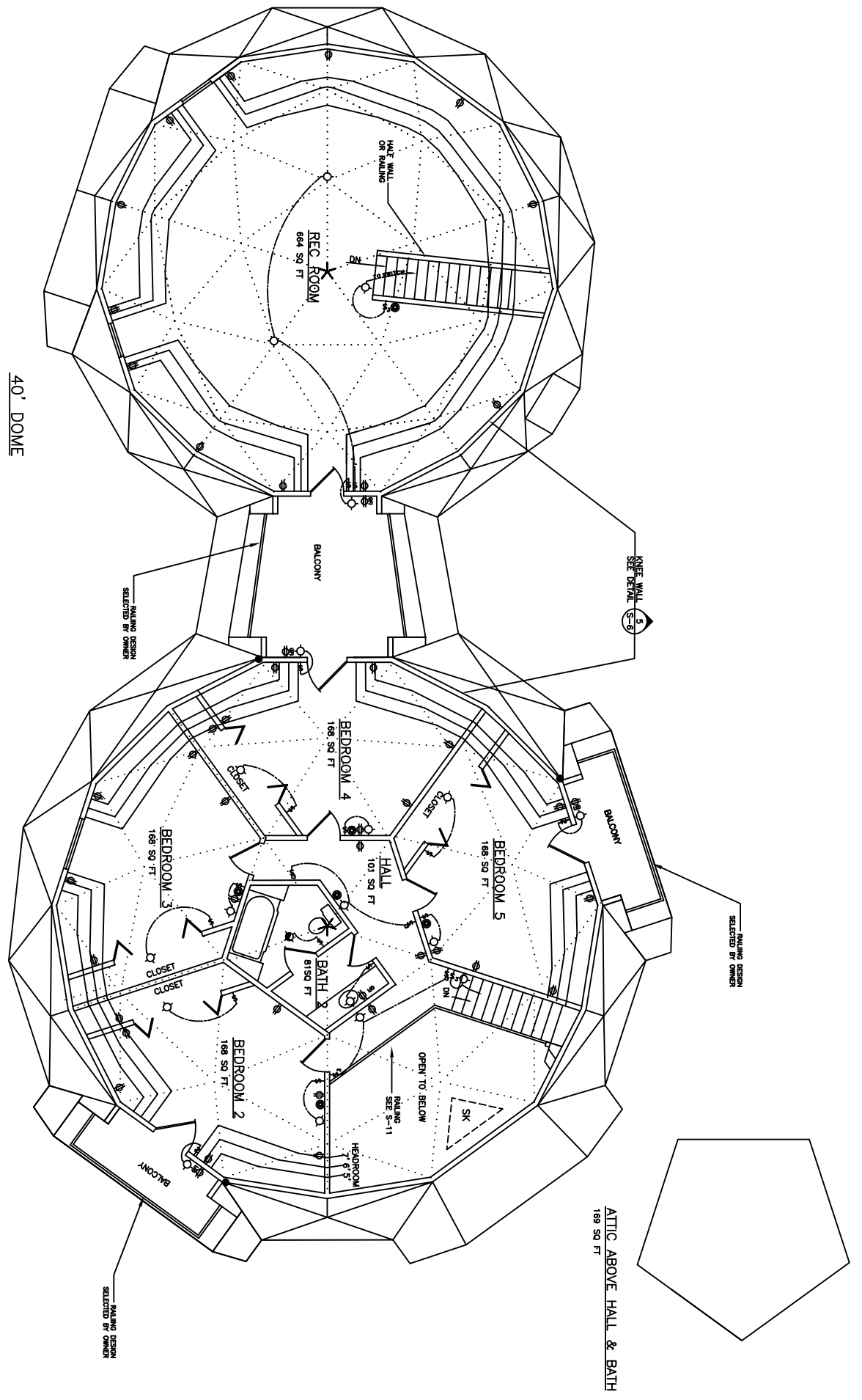

SECOND FLOOR PLAN

SCALE: XXX" = 1'-0"  
 48' DOME 1003 SQ.FT  
 40' DOME 672 SQ.FT  
 TOTAL: 1675 SQ.FT

SHEET NO.  
**A-4**  
 COPYRIGHT 2011  
 AMERICAN INGENUITY, INC.

**AMERICAN INGENUITY, INC.**  
 8777 HOLIDAY SPRINGS RD  
 ROCKLEDGE, FL 32955-5805 USA  
 PH. 321-639-8777

DOMES PLANS FOR:  
**MARSHALL RESIDENCE**  
 SHEET TITLE:  
**2ND FLOOR PLAN**

DRAWN BY: N.K.H.  
 CHECKED BY: M.B.  
 DATE: 5/26/11  
 DRAWING NO: 48-40\_MARSHALL  
 REVISION: