

NOTES:

1. CRITICAL DIMENSIONS ARE GIVEN OTHER SCALE MEASURED FOR BEARING WALL LOCATION DIMENSIONS.
2. INTERIOR WALLS ARE DIMENSIONED TO THEIR CENTERLINE UNLESS OTHERWISE NOTED.
3. INTERIOR WALL THICKNESS SHOWN IS 4 1/2", 3 1/2" FRAMING PLUS 1/2" WALL BOARD ON BOTH SIDES.
4. RAD-C INDICATES THE RADIUS TO THE CENTER OF THE FLOOR.
5. A.V.D.G. INDICATES INTERIOR WALL SEGMENTS THAT ALIGN WITH DOME GEOMETRY OR PANEL SEAMS ABOVE.
6. ELECTRICAL SWITCHES, OUTLETS AND FIXTURES MAY BE CHANGED ON SITE AT DWYERS DISCRETION PROVIDED THAT THE FINAL DESIGN COMPLETES WITH APPLICABLE CODE.
7. ALL BEDROOMS THAT DO NOT HAVE AN ALTERNATE EXIT MUST HAVE A MINIMUM WIDTH OF OPENING 20". MINIMUM HEIGHT 24". MIN. CLEAR OPEN AREA 5.7 SQ. FT. MAXIMUM HEIGHT FROM THE FLOOR TO THE BOTTOM OF THE OPENING 44".

STAIRS TO SECOND FLOOR:
 DISTANCE BETWEEN FLOORS = 40"
 MINIMUM TREAD WIDTH = 10'-1/2"
 MINIMUM TREAD WIDTH = 36"

1ST FLOOR PLAN
 SCALE: 1/4" = 1'-0"
 AREA: 1,490 SQ. FT.

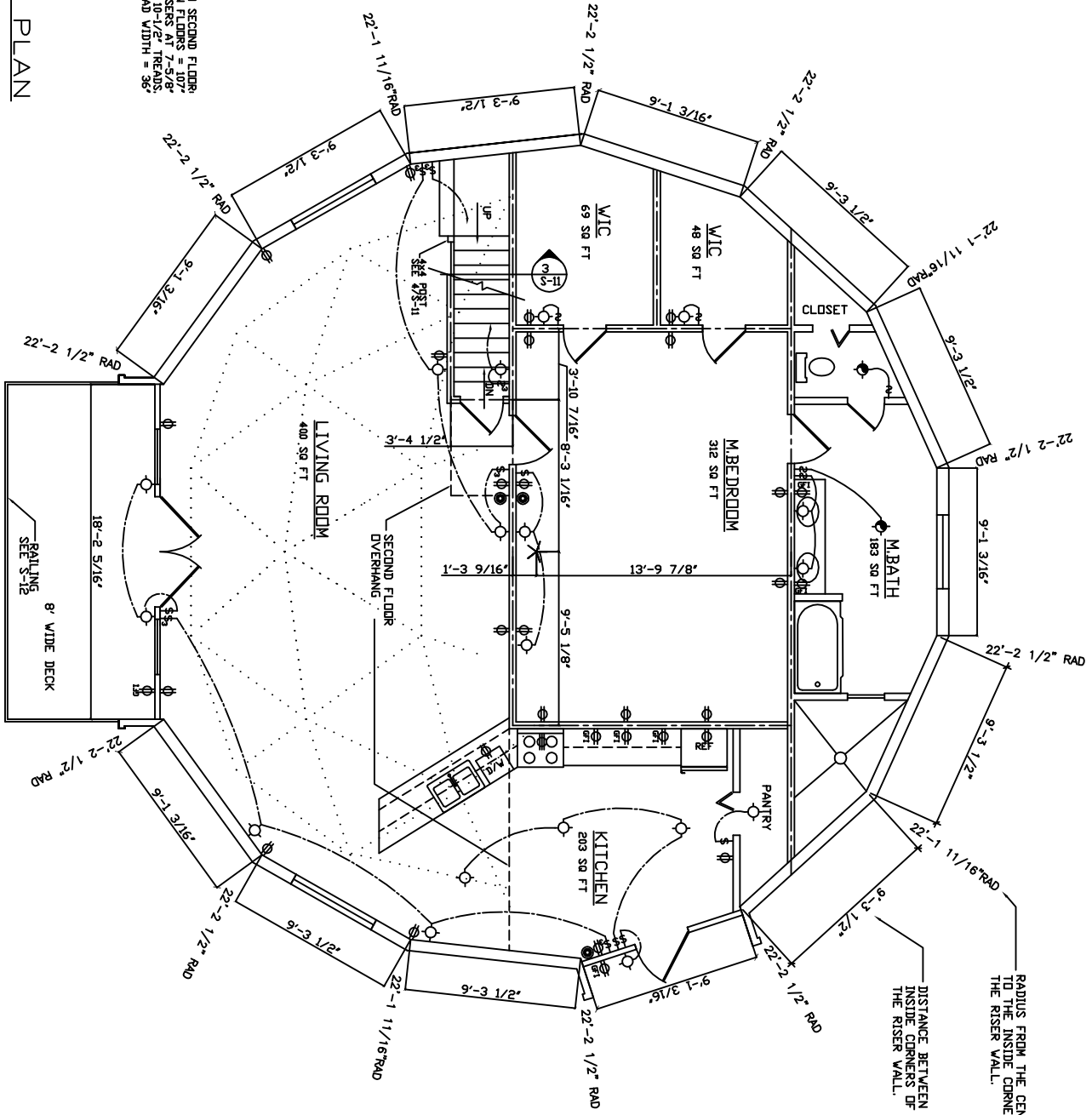

RADIUS FROM THE CENTER OF THE RISER WALL TO THE INSIDE CORNER OF THE RISER WALL.

DISTANCE BETWEEN INSIDE CORNERS OF THE RISER WALL.

AMERICAN INGENUITY
 8777 HOLIDAY SPRINGS RD
 ROCKLEDGE, FL 32955-5805
 PH. 321-639-8777 USA

DOME PLANS FOR:
STROUPE RESIDENCE
 SHEET TITLE:
1ST FLOOR PLAN

DRAWN BY: N.K.H.
 CHECKED BY: M.B.
 DATE: 9/16/08
 DRAWING NO: 45_STROUPE
 REVISION:

SHEET NO.:
A-3
 COPYRIGHT 2004
 AMERICAN INGENUITY, INC.