

NOTES

1. CRITICAL DIMENSIONS ARE GIVEN. OTHER MAY BE SCALE MEASURED. SEE SHEET S-1 FOR BEARING WALL LOCATION DIMENSIONS.
2. INTERIOR WALLS ARE DIMENSIONED TO THEIR CENTERLINE UNLESS OTHERWISE NOTED.
3. INTERIOR WALL THICKNESS SHOWN IS 4 1/2", 3 1/2" FRAMING PLUS 1/2" WALL BOARD ON BOTH SIDES.
4. RAD-C INDICATES THE RADIUS TO THE CENTER OF THE FLOOR.
5. A.V.D.G. INDICATES INTERIOR WALL SEGMENTS THAT ALIGN WITH DOME GEOMETRY OR PANEL SEAMS ABOVE.
6. ELECTRICAL SWITCHES, OUTLETS AND FIXTURES MAY BE CHANGED ON SITE AT OWNER'S DISCRETION PROVIDED THAT THE FINAL DESIGN COMPLES WITH APPLICABLE CODE.
7. ALL BEDROOMS THAT DO NOT HAVE AN ALTERNATE EXIT MUST HAVE WINDOW QUALIFIED FOR EGRESS. MINIMUM WIDTH OF OPENING 20", MINIMUM HEIGHT 24", MIN. CLEAR OPEN AREA 5.7 SQ. FT., MAXIMUM HEIGHT FROM THE FLOOR TO THE BOTTOM OF THE OPENING 44".

SEE S-1 FOR BASEMENT WALLS DIMENSIONS

DEPENDING ON HEIGHT OF BASEMENT WALLS STAIR SPECIFICATIONS MAY CHANGE PROVIDED THEY COMPLY WITH LOCAL BUILDING CODE.

STAIRS TO FIRST FLOOR WITH A DISTANCE BETWEEN FLOORS OF 121" 16 RISERS AT 7-1/2" RUN = 9-1/2" + RISING = 10-1/2" TREADS. MINIMUM TREAD WIDTH = 36"

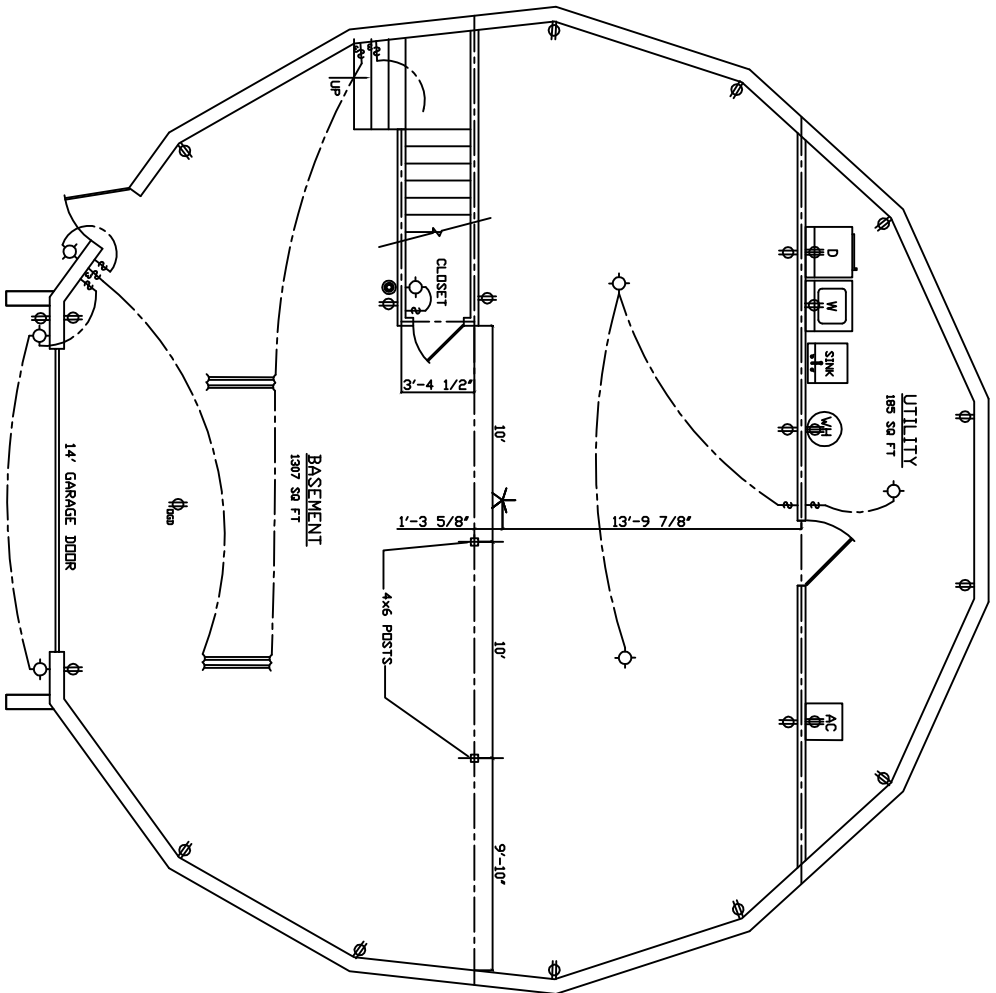

BASEMENT FLOOR PLAN

SCALE: 1/4" = 1'-0"  
 AREA: 1,492 SQ. FT.

SHEET NO.  
**A-5**

**AMERICAN  
 INGENUITY**  
 8777 HOLIDAY SPRINGS RD  
 ROCKLEDGE, FL 32955-5805  
 PH. 321-639-8777 USA

DOME PLANS FOR:  
**STROUPE RESIDENCE**

SHEET TITLE:  
**BASEMENT FLOOR PLAN**

DRAWN BY: N.K.H.  
 CHECKED BY: M.B.  
 DATE: 9/16/08  
 DRAWING NO: 45\_STROUPE  
 REVISION: